

USP490KV

Ultra-Slim Profile

Placement with Room to Spare



This sleek design, combined with their light weight and commercial reliability, makes USP displays ideal for a wide range of signage applications. Custom framing options are available to ensure that your digital signage is both eye-catching and in keeping with the theme of your space.



Highlights

1.54 inches slim.

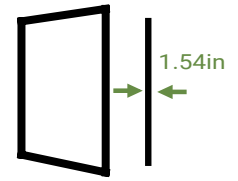

Secure-Ready” = No NFC, RF, WiFi, or embedded computing.



Perfect to replace traditional “light boxes”, menu boards, or other static signage.



Video wall-capable (DP output and video wall mode).

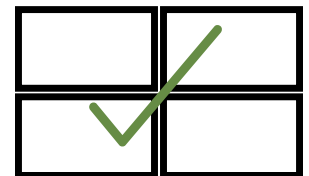

Specifications

Panel Attributes

| | |
|-----------------------|--|
| Panel Technology | Commercial-grade IPS / Direct-LED back light |
| Surface Treatment | Hard Coating (2H), Anti-glare treatment of front polarizer (Haze 28%) |
| Screen Size (diag.) | 48.5" |
| Native Resolution | 3840 x 2160 |
| Active Area (mm) | 1073.8 X 604 |
| Brightness (typ.) | 500nit |
| Contrast Ratio (typ.) | 1,100:1 / 500,000:1 (DCR) |
| Displayable Colors | 10bit(D), 1.07 Billion colors |
| Viewing Angle | 178° / 178° |
| Aspect Ratio | 16:9 |
| Refresh Rate | 60Hz |

Specifications

Dimensions, Power & Other

| | |
|---|--|
| Display Dimensions (W x H x D) + Weight | Without Mount: 43.20 x 24.80 x 1.52 (in) - 40lbs With Mount: 43.20x 24.80 x 1.54 (in) - 41lbs |
| Boxed Dimensions (W x H x D) + Weight | 47.64 x 31.50 x 9.84 (in) - 50lbs |
| Packed Pallet Dimensions (W x H x D) + Weight | 55 x 37 x 22 (in) - 74lbs * <i>*single display approx.- contact us for higher q'tys</i> |
| Display Orientation | Landscape or Portrait |
| Heat Output (BTU/hr) | 307 |
| Mounting Pattern (mm) | 300 x 300 |
| Electrical Ratings | AC 100 - 240V (50/60Hz) |
| Power Consumption (typ.) | 90W |
| Standby Power Consumption | <1W |
| Operating Temperature | 32°F -104°F |
| Operating Humidity Range | 10~90% |
| Industrial Reliability | 60,000+ Hours |
| Usage Ratings (hrs/days) | 24/7** |
| Warranty | One Year (parts & labor) |

****Consult with GPO Display regarding best practices for preventing image retention and for prolonging display lifetime.**

Connectivity

| | |
|-------------------------------|-----------------------|
| HDMI (up to 3840 x 2160 60Hz) | 3 x input |
| DisplayPort | 2 x input, 1 x output |
| RS-232 | 1 x input, 1 x output |

Accessories:

- RS-232 cable x1
- DP cable x1
- AC power cord x1
- Remote control x1
- Batteries for remote control

Includes:

- Wall mount

Portrait Drawings

Front View

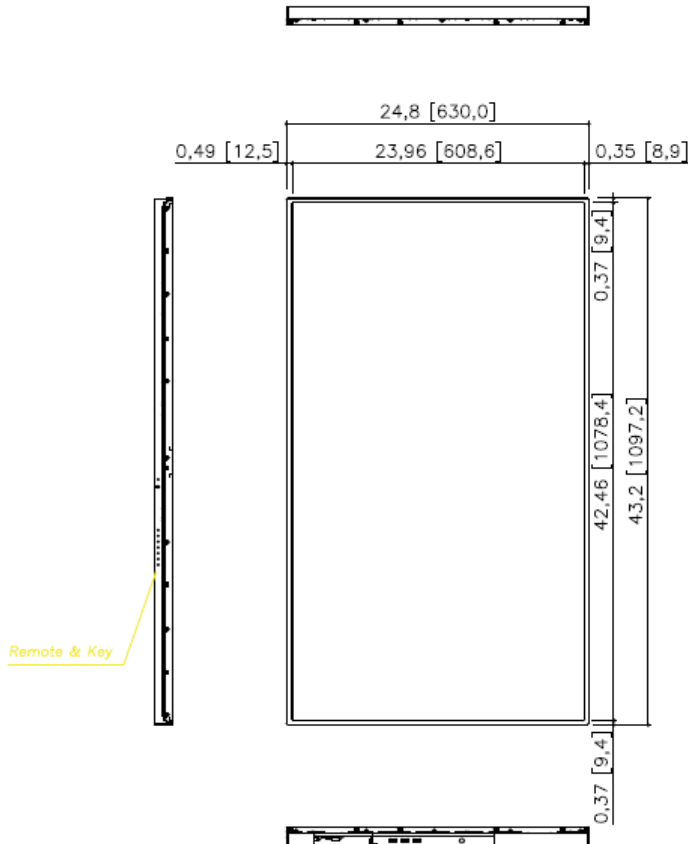

Rear View

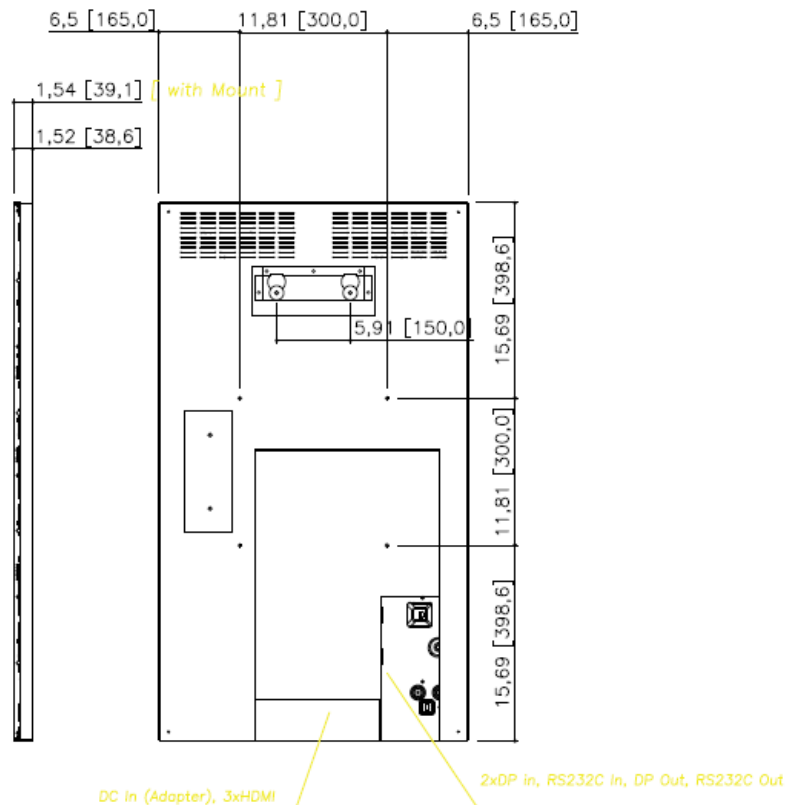

Product specification and design are subject to change without notice.
 Copyright 2024, GPO Display All rights reserved. This document may not be copied in any form without written permission from GPO Display

Landscape Drawings

Front View

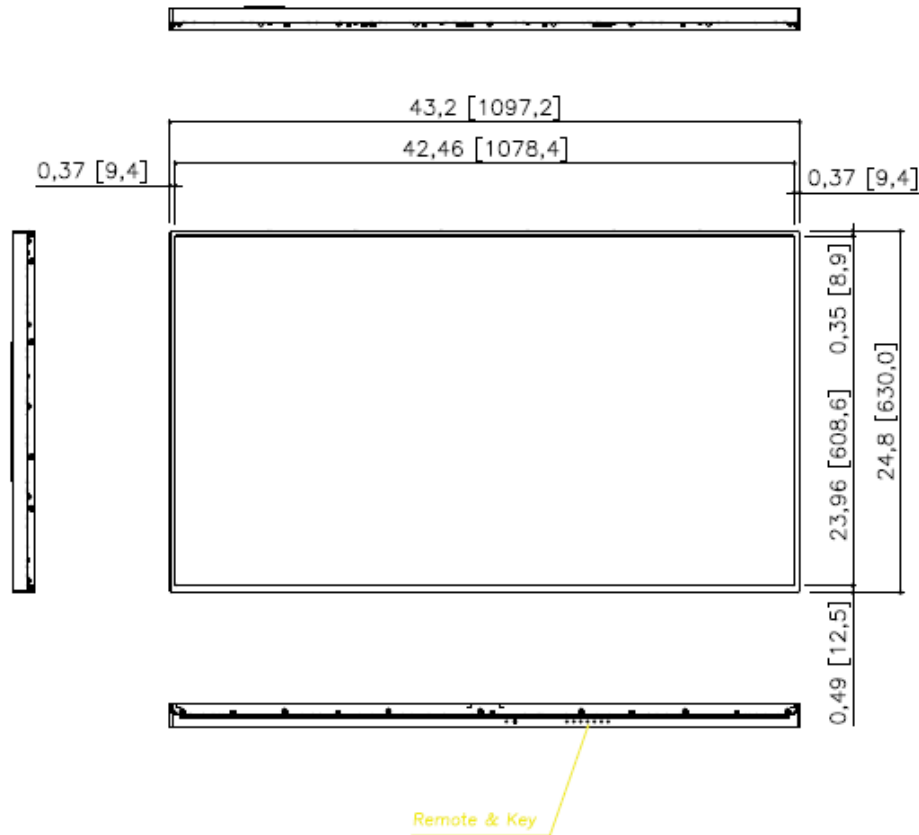

Rear View

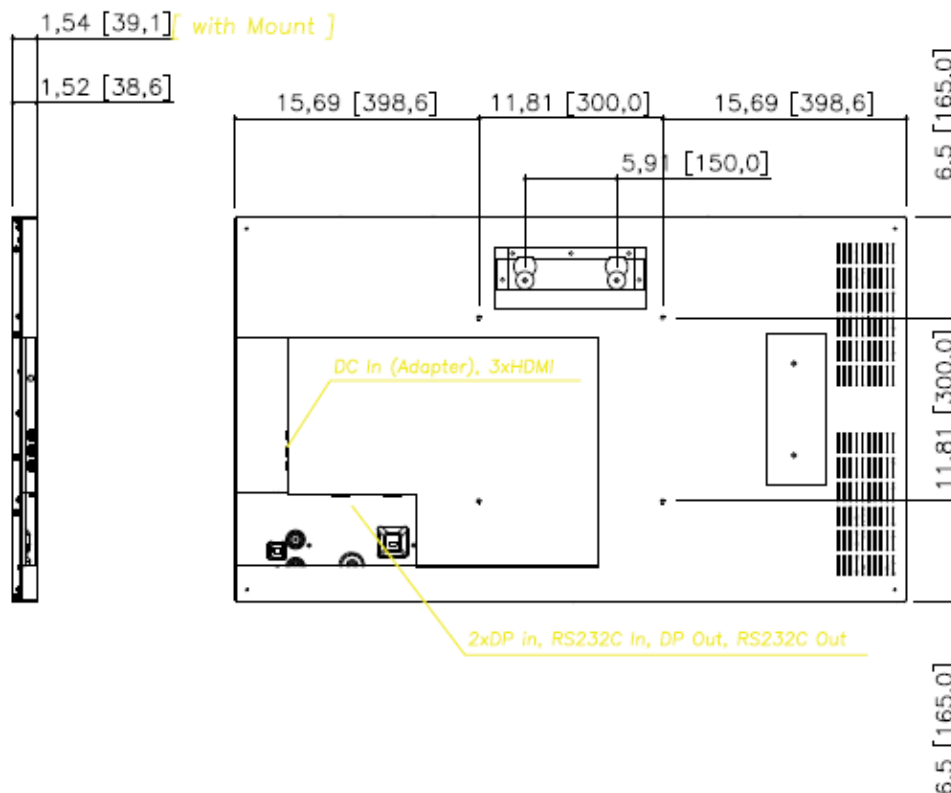

Product specification and design are subject to change without notice.

Copyright 2024, GPO Display All rights reserved. This document may not be copied in any form without written permission from GPO Display

